

# Tree Survey Drawing

Western Avenue, Bridge

Bridge Parish Council



This drawing and design are the copyright of Lloyd Bore Ltd. Do not scale from this drawing.

All dimensions to be checked on site by contractor prior to commencement of any work.

All materials, components and workmanship shall comply with the relevant British Standards, Codes of Practice and manufacturers written instructions.



1:500  
T1-T9 & G1

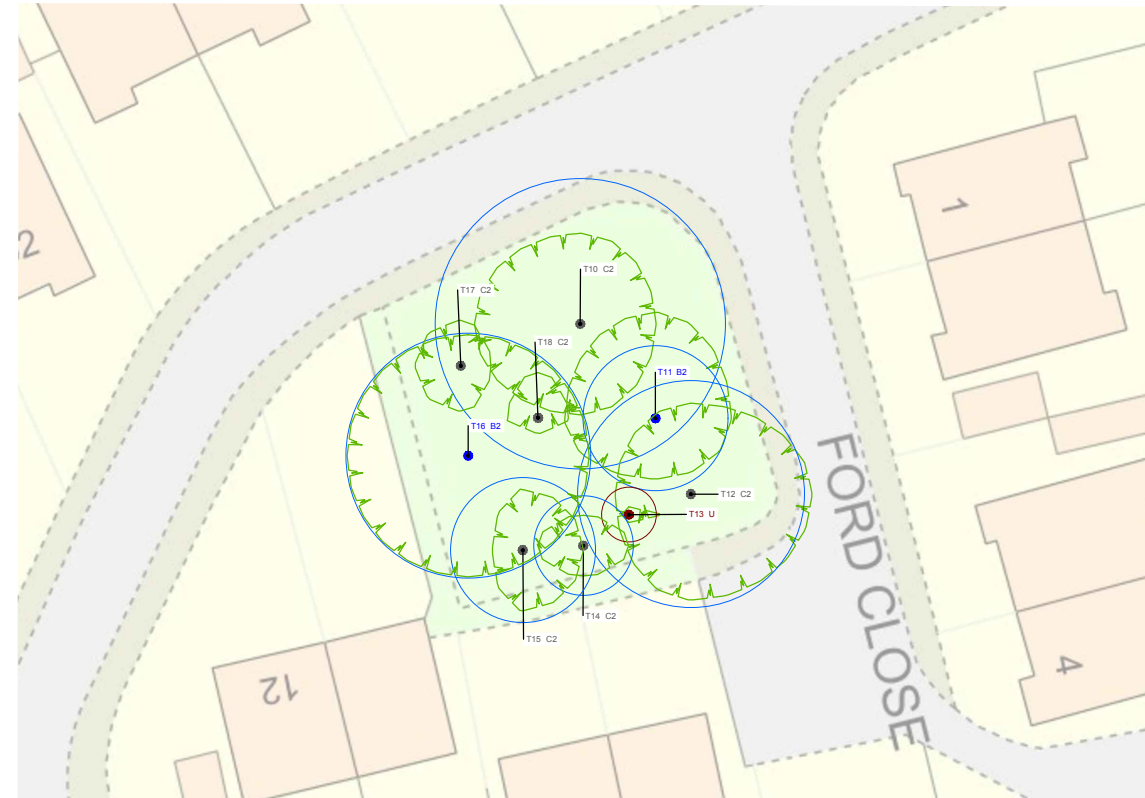

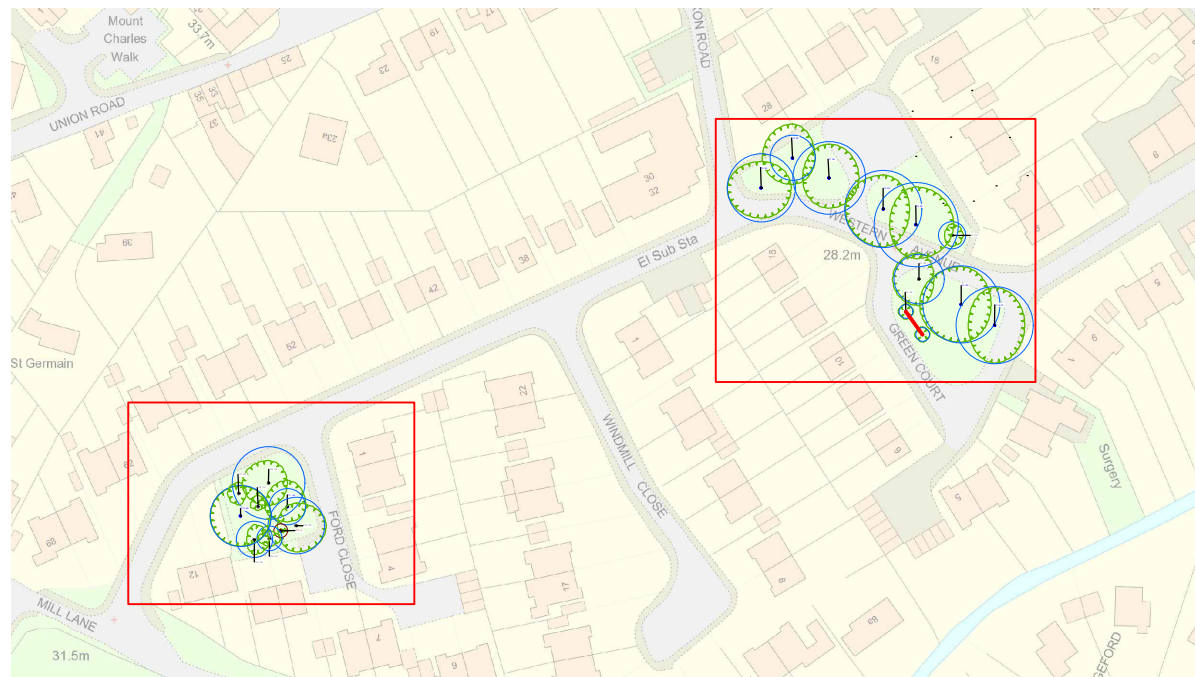

1:500  
T10-T18



1:2000

**LEGEND:**

-  Tree Canopy
-  Root Protection Area
-  Group Line

Tree Survey Schedule				
Surveyed Trees				
Ref.	Species	Height	Stem ?	B.S Cat.
G1	Ash and holly	8m	0.15m	C2
T1	Beech	11m	0.84m	B1/2
T2	Holm oak	12m	0.300; 0.300; 0.300; 0.300; 0.300; 0.300; 0.300m	B2
T3	Horse chestnut	8m	0.56m	C2
T4	Silver birch	8m	0.29m	C2
T5	Holm oak	12m	0.260; 0.260; 0.260; 0.260; 0.260; 0.260; 0.260; 0.260; 0.260; 0.260; 0.260m	B2
T6	Beech	12m	0.86m	B2
T7	Holm oak	11m	0.400; 0.310; 0.380; 0.480m	B2
T8	London plane	9m	0.49m	B2
T9	Beech	12m	0.74m	B2
T10	Horse chestnut	9m	0.79m	C2
T11	Silver birch	14m	0.41m	B2
T12	Sycamore	12m	0.360; 0.300; 0.300; 0.270m	C2
T13	Hawthorn	7m	0.14m	U
T14	Hawthorn	7m	0.100; 0.100; 0.100; 0.100; 0.100; 0.100m	C2
T15	Hawthorn	8m	0.200; 0.150; 0.220; 0.130; 0.200m	C2
T16	Sycamore	12m	0.390; 0.380; 0.380m	B2
T17	Holm oak	5m	0m	C2
T18	Hawthorn	6m	0m	C2

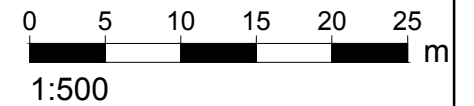

rev. revision note. rev date: 01/03/16

drawing no. 3765\_DR\_001

client & project:  
**Bridge Parish Council**  
**Western Avenue**  
**Bridge**  
**CT4 5LS**

drawing title:  
**Tree Survey Drawing**

status: Reference  
scale: 1:500 drawn by: TB  
sheet: A3 checked by: IL



33 ST GEORGE'S PLACE  
CANTERBURY  
KENT CT1 1UT

t: 01227 464 340  
e: mail@lloyd bore.co.uk  
w: www.lloyd bore.co.uk